

TITAN

I N D U S T R I A L

P.O.Box 791, Travelers Rest, S.C. 29690

Phone 864-834-7212

Service/Replacement Parts 800-845-4141



OWNER'S MANUAL

MODEL TG 7500D Industrial Generator

The Emission Control System for this generator is warranted for standards set by the Environment Protection Agency.

IMPORTANT!

It is extremely important to read and understand the entire contents of this Owner's Manual for the Titan Industrial Model TG 7500D before attempting to operate the generator. This is a diesel engine powered, industrial strength generating unit of electrical power. The diesel engine and the generator are both potentially extremely hazardous and could cause physical injury or even death if improperly used.

WARNING!

Do Not Operate Equipment until reading & understanding Owner's Manual!
Disconnect all loads before starting or stopping generator.
Allow to run for a few minutes with no load before stopping.

**IMPORTANT !
READ FIRST**

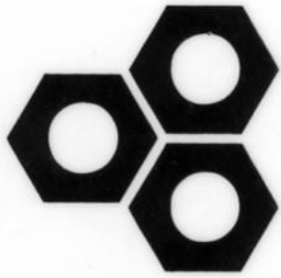

TITAN
I N D U S T R I A L

**OWNER'S MANUAL
MODEL TG 7500D
Industrial Generator**

It is extremely important to read and understand the entire contents of this Owner's Manual for the Titan Industrial- Model TG 7500D before attempting to operate the generator. This is a diesel engine powered, industrial strength generating unit of electrical power. The diesel engine and the generator are both potentially extremely hazardous and could cause physical injury or even death if improperly used.

TITAN INDUSTRIAL shall not be responsible for any consequences resulting from improper use of this equipment. The operator is required to read the entire contents of this manual before attempting to operate the unit. If the operator does not completely understand the instructions and all of the hazards of operating this unit after reading this manual, he must call the factory at 1-800-845-4141 to answer these questions to his/her complete satisfaction before proceeding.

READ AND COMPLETELY UNDERSTAND entire contents of this Owner's Manual and become familiar with the unit before attempting to start using this equipment! It is your responsibility to know its applications, limitations, and hazards! Call the factory at 1-800-845-4141 with any questions.

FOR OUTDOOR USE ONLY! Never use this unit inside any enclosure including the generator compartment of a recreation vehicle (RV) or inside any building. No modifications will eliminate the danger of possible carbon monoxide poisoning, fire, or explosion.

TWO (2) FEET OF CLEARANCE on all sides is required even while using outdoors.

THIS UNIT IS SOLD SOLELY FOR THE PURPOSE OF PORTABLE POWER. OTHER APPLICATIONS COULD VOID WARRANTY. USER ACCEPTS RESPONSIBILITY FOR INJURIES AND/OR DAMAGE RESULTING FROM OTHER APPLICATIONS.

This Manual contains information to ensure your safety and to prevent any equipment problems. Various terms such as 'WARNING', 'CAUTION', 'DANGER', 'IMPORTANT', and the SYMBOL → are all used to signify information that is essential for the operator of this equipment to understand and to practice!

CONNECTING LOADS

Add up the Watts of all devices you connect to the TITAN INDUSTRIAL GENERATOR at one time. Do not exceed 6800 Watts on TITAN INDUSTRIAL Generator Model TG 7500D (see wattage reference guide).

The rated Watts of most electrical devices can be found on its nameplate. The rated Watts of lights can be taken from the light bulbs. In cases where only Volts and Amps are shown on the nameplate, simply multiply Volts by the Amps to get Watts (Volts X Amps = Watts).

Some electric motors require about **three** times the rated Watts of power for start-up. This surge of power is required for only a few seconds. Be sure to allow for this high starting wattage when selecting electrical devices to connect to the generator.

First, figure the watts needed to start the largest motor. Add to that figure the running watts of all other connected loads.

Please see the Wattage Reference Guide. It provides an **estimated** approximation of running watts, to help determine which devices to select to connect to the generator.

CAUTION! Do not tamper with engine governed speed. The TITAN INDUSTRIAL GENERATOR supplies correct rated frequency and voltage when running at the proper governed speed. Incorrect frequency and/or voltage could damage connected electrical devices. Changing settings voids the warranty.



P.O. Box 791
Travelers Rest, S.C. 29690
864-834-8550
Toll Free 1-888-828-8126
Replacement Parts 1-800-845-4141

MODEL TG 7500D DIESEL POWERED ELECTRIC GENERATOR

Model	TG 7500
Voltage	120/240
Frequency	60Hz
Continuous Watts.	6000
Surge Watts.	6800

DESCRIPTION

THE TITAN INDUSTRIAL INC. MODEL TG 7500D is a diesel engine driven, revolving field, alternating current (AC) generator designed to supply electrical power for compatible electrical tools, motors, appliances, and lighting (see wattage reference guide on page 6).

The Model TG 7500D operates at 120 volt and/or 240 volt, single phase, 60 Hz and will operate devices that require up to 6000 watts. continuous and 6800 surge watts at 240 Volts.



GROUNDING THE GENERATOR

It is required by The National Electrical Code to have the frame and all external conductive parts of the generator connected to an earth ground. Proper grounding also satisfies most local electrical codes.

Connect a No. 12 AWG standard copper wire to the Grounding Lug Block (See Figure 1). The grounding lug is located on the control panel. Connect the other end of the wire to an earth driven copper or brass grounding rod (electrode).

CAUTION! Do not connect ground to a preexisting ground rod, water pipe, or building frame.

Consult with a licensed electrician in your area because local codes vary. Properly grounding the generator helps prevent electrical shock if a ground fault condition exists in the generator or in connected electrical devices. This will also help to dissipate static electricity resulting from ungrounded devices.

⚡ SAFETY ⚡

This generator was designed for specific applications. DO NOT attempt to modify the unit in any way or use it for any application that it was not designed to do. Ask the dealer or contact the factory if you have any questions concerning the generator's application.

Warnings and cautions in this manual and on decals and tags on the unit are not all inclusive. It would be impossible to anticipate every circumstance that might involve a hazard. Handling, operating, or servicing this unit by any procedure not recommended by the manufacturer may render this equipment unsafe and may pose a threat to you or to others.

- ⚡ The generator produces a very powerful voltage that can cause extremely dangerous electrical shock. Avoid contact with bare wires, terminals, etc. never permit an unqualified person to operate or service the generator.
 - ⚡ Never handle any kind of electrical cord or device while standing in water, while barefoot or with wet hands or when feet are wet. Dangerous electrical shock could result.
 - ⚡ The National Electric Code requires that the frame and external conductive parts be properly connected to an approved earth ground. Local electrical codes may vary. Check with an electrician for local grounding requirements.
 - ⚡ Use a ground fault circuit interrupter in any damp or highly conductive area such as metal decking or steel work.
 - ⚡ Do not use worn, bare, frayed or otherwise damaged electrical cords or wiring with the generator. A defective cord may result in electrical shock or may cause damage to equipment.
 - ⚡ Do not expose unit to excessive moisture, dirt or corrosive vapors. Unit must be operated on a level surface.
 - ⚡ Comply with all laws regulating the storage and handling of diesel fuel. Diesel fuel is highly flammable and explosive. Avoid spilling diesel fuel on a hot engine. Do not allow smoking, open flames, sparks or heat in the vicinity while handling diesel fuel.
 - ⚡ Do not overfill the fuel tank. Leave one inch below fill neck. Always allow room for diesel fuel expansion. Diesel fuel could overflow and cause fire or explosion if tank is overfilled. Allow for a 20 minute cool down before refueling. Never refuel tank while engine is running.
- ⚡ Only operate this unit outside with adequate ventilation. This generator's diesel engine exhaust produces carbon monoxide gas that can cause unconsciousness or even death.
 - ⚡ Never store a generator with fuel in the tank where diesel fuel vapors could be ignited by a flame, spark, or pilot light from an appliance such as a furnace, water heater, or clothes dryer or other sources of heat.
 - ⚡ Always allow a minimum of 2 feet of clearance on all sides for ventilation while unit is operating. Allow 2 feet of clearance from all combustibles.
 - ⚡ Generator must always be stopped or started with all loads unconnected. Start the engine and let it stabilize before connecting any loads. Disconnect all loads before shutting down the generator. Change oil per published schedule
 - ⚡ Never insert any object through the cooling slots of the engine. You could damage the unit or cause injury.
 - ⚡ NEVER OPERATE THE GENERATOR:
 - In rain
 - In an enclosed compartment
 - If connected devices overheat
 - If electrical output is lost
 - If engine or generator sparks
 - If flame or smoke is observed
 - If unit vibrates excessively

CAUTION! The engine exhaust contains chemicals known to the State of California to cause cancer, birth defects, or other reproductive harm.

CAUTION! If it is your first time starting the generator, allow it to run for 30 minutes before connecting electrical loads. This is for wet seating purposes

CAUTION: Customer takes full responsibility for use of this unit as a home generation system.

IMPORTANT ! IMPORTANT ! IMPORTANT ! IMPORTANT ! IMPORTANT

BEFORE STARTING THE ENGINE

CHECK AND/OR FILL OIL

WARNING!
DO NOT ATTEMPT TO START THE ENGINE BEFORE FILLING WITH OIL!

**Titan Industrial
Recommends
ONLY
Using Rotella T
Multigrade
15W - 40 Type
engine oil.**

Fill with oil

- Place generator on a level surface.
- Clean area around oil fill opening.
- Remove the dipstick.
- Wipe the dipstick clean.
- Pour oil in until it reaches the FULL mark on dipstick.
- **DO NOT OVERFILL!**
- **CLOSE OIL CAP!**
Change oil as published

CHECK AND/OR FILL DIESEL

WARNING!
Do not overfill! Leave room for fuel expansion. Never fill fuel indoors. Never fill fuel when engine is hot or running. Do not smoke or fill fuel near an open flame or sparks.

Fill with diesel fuel only

- Use diesel fuel only.
- Clean area around fuel cap.
- Remove fuel cap.
- Add diesel fuel to fuel tank.
- DO NOT overfill. Do not fill above the red plug inside the fuel tank filter (this allows for fuel expansion).
- Replace fuel cap.
- Wipe up any spilled diesel fuel.

Note:

Because this is a diesel engine, frequent oil and filter changes are required.

CHECK AND/OR REPLACE FILTER

WARNING!
Do not clean filter with any type of detergent.

Check air filter

- Remove cover panel. Loosen wingnut and remove air filter cover.
- Never wash air cleaner with any kind of detergent or cleaning solvent.
- Air filter should be changed if engine performance decreases or color of exhaust changes.
- Never run engine without air filter. This can cause rapid engine wear.

Figure #2 - Air Filter Housing

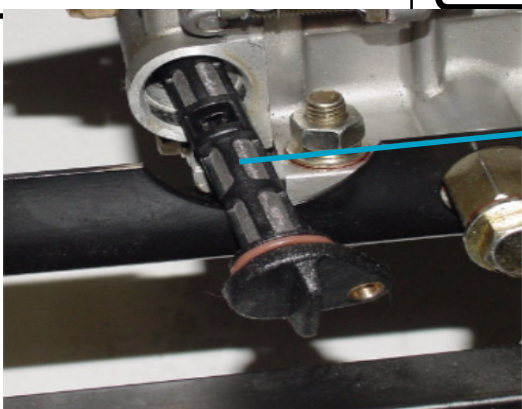

Oil Filter\Screen

Oil Capacity 1.2 U.S. Qts.

Oil Drian Plug

Clean/Change filter after the first 5 hours of operations.

Change oil every 30 hours, or sooner in adverse conditions. Replace/Clean oil filter each and every time oil is changed. Failure to do so, will cause engine damage and void the warranty.

Wattage Reference Guide

Device		Running	Device		Running	
Watts	*Air Conditioner (12,000 BTU)	1700	Watts	Impact Wrench	500	
	Battery Charger (20 Amp)	500		*Jet Pump	800	
	Belt Sander (3")	1000		Lawn Mower	1200	
	Chain Saw	1200		Light Bulb	100	
	Circular Saw (6-1/2")	800 to 1000		Microwave Oven	700	
	Coffee Maker	1000		*Milk Cooler	1100	
	Compressor (1 HP)	2000		Oil Burner on Furnace	300	
	Compressor (3/4 HP)	1800		Oil Fired Space Heater (140,000 BTU)	400	
	Compressor (1/2 HP)	1400		Oil Fired Space Heater (85,000 BTU)	225	
	Curling Iron	700		Oil Fired Space Heater (30,000 BTU)	150	
	*Freezer	500		*Airless Paint Sprayer (1/3 HP)	600	
	Disc Sander (9")	1200		Handheld Airless Paint Sprayer	150	
	Edge Trimmer	500		Electric	Radio	50 to 200
	Nail Gun	1200		Refrigerator	600	
	Electric Range (one element)	1500		Slow Cooker	200	
	Electric Skillet	1250		*Submersible Pump (1-1/2 HP)	2800	
	*Furnace Fan (1/3 HP)	1200		*Submersible Pump (1 HP)	2000	
	Hair Dryer	1200		*Submersible Pump (1/2 HP)	1500	
	Hand Drill (1")	1100		Sump Pump	600	
	Hand Drill (1/2")	750 to 1000		*Table Saw (10")	1750 to 2000	
Hand Drill (3/8")	500	Television	200 to 500			
Hand Drill (1/4")	250	Weed Trimmer	500			

*Allow 3 times the listed Watts for starting these devices
 These wattages shown are approximate and may vary with each specific device

WARNING:

Factory warranty is voided if fuel, other than specified diesel fuel, is used in this engine. Refer to owners manual for fuel.

Maintenance Guide

	DAILY	EVERY MONTH/ 30 HRS	EVERY 3 MONTHS/ 100 HRS	EVERY 6 MONTHS/ 500 HRS
Check/Refill Fuel	X			
Drain fuel from tank		X		
Check/Refill Oil	X			
Check for oil leakage	X			
Change oil		X*		
Clean/Replace oil filter		X		
Replace air filter		X*	X*	
Clean/Replace fuel filter				X

*First oil change should be after 5 hours. After initial break-in period change oil every (30) hours.

X* Air filter may need to be replaced frequently, due to adverse conditions. Check filter frequently.

OPERATION OF THE GENERATOR

CAUTION!

DO NOT start or stop the engine with electrical loads connected to the receptacles. Be certain connected devices are OFF before connecting or disconnecting.

DANGER!

DO NOT run generator indoors or in poorly ventilated areas. Engine exhaust contains carbon monoxide which is an odorless, deadly gas.

WARNING!

To avoid burns, avoid muffler and nearby areas.

Starting the Engine - Recoil starting

1. Be sure unit is at a level, well ventated position.
2. Check fluid for proper levels
3. Turn on fuel valve. (figure #3)
4. Put Throttle lever to the run position (figure #5)
5. Turn ignition key on control panel to the run positon.
6. Push and hold down the decompression lever (figure #4)
Pull the recoil starter briskly until the engine is rotating, then, release lever.
7. Let engine settle before attaching any appliances

Figure #3 - Fuel Valve Positions

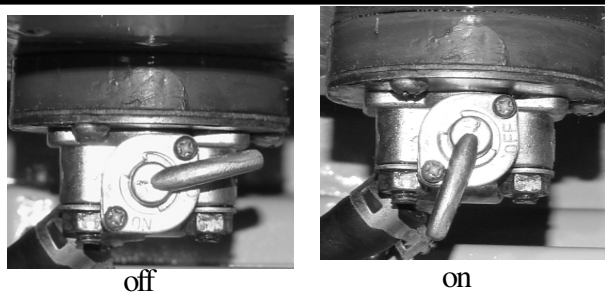

Starting the Engine - Electric starting

1. Be sure unit is at a level, well ventated position
2. Check fluids for proper levels.
3. Turn on fuel valve. (figure #3)
4. Put Throttle lever in the run position (figure #5)
5. Turn the ignition key to the “Start” position
6. Once engine has started return the key to the “ON”
7. Let engine settle before attaching any appliances

Figure #5

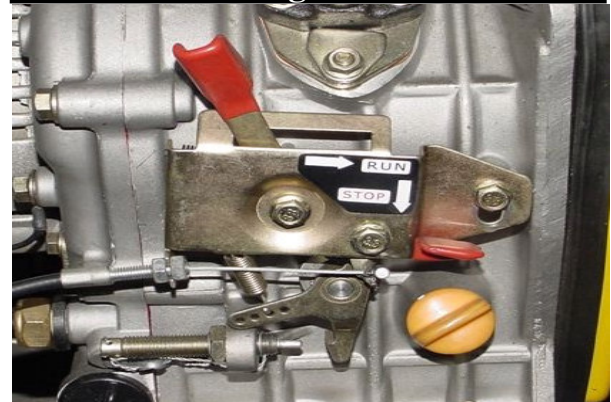
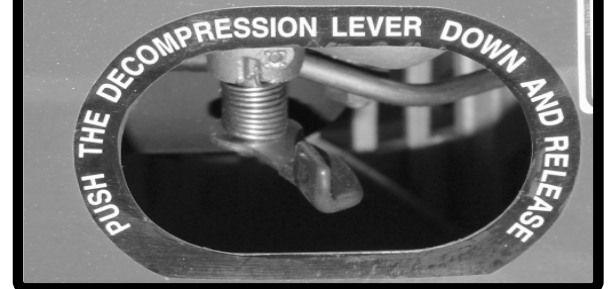

Figure #4 - Compression Release Switch



OPERATION OF THE GENERATOR

Bleeding Instructions

Figure #6

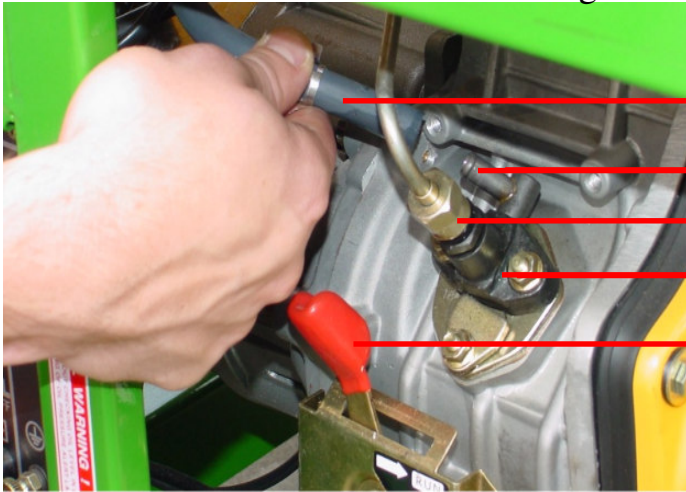

- Rubber Fuel Line
- Fuel Pump Port
- Steel Fuel Line
- Fuel Pump
- Throttle Lever

1. With the fuel valve in the off position take off the rubber fuel line off the fuel pump port.
2. Open fuel valve and let rubber fuel line fill up with diesel fuel. Quickly replace rubber fuel line on the fuel pump port
3. Follow starting procedure (page 7)

If the unit still won't start.

1. Loosen/remove the steel fuel line compression nut so you can see the top of the fuel pump. (figure #6)
2. With the throttle lever in the run position turn over the engine. Diesel fuel should squirt out to the top of fuel pump.
- * **If no fuel is coming out of pump retry bleeding procedures, if still no fuel, possible bad fuel pump.**
3. Reconnect fuel line and follow starting procedures.

Fuel pumping but unit will not start.

1. Follow the steel fuel line up to the injector
2. Disconnect the fuel line from the injector with a 17mm wrench (figure #7)
3. Remove the fuel injector from head assembly and inspect it. Make sure injector tip is clean and free from debris. Invert it. Reconnect metal fuel line. (figure #8)
4. With the throttle lever in the run position turn over the engine. You should have four ports of fuel spraying from the injector tip.
5. Re-install injector in to the head assembly
6. Follow starting procedures.

If the fuel injector does not spray (possible bad injector)
 If the fuel injector is functioning, look under the valve cover to see if the valves are function properly.

Figure #7

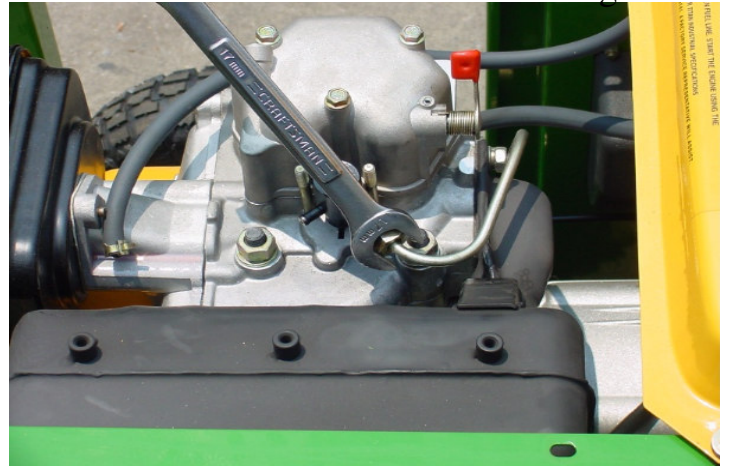
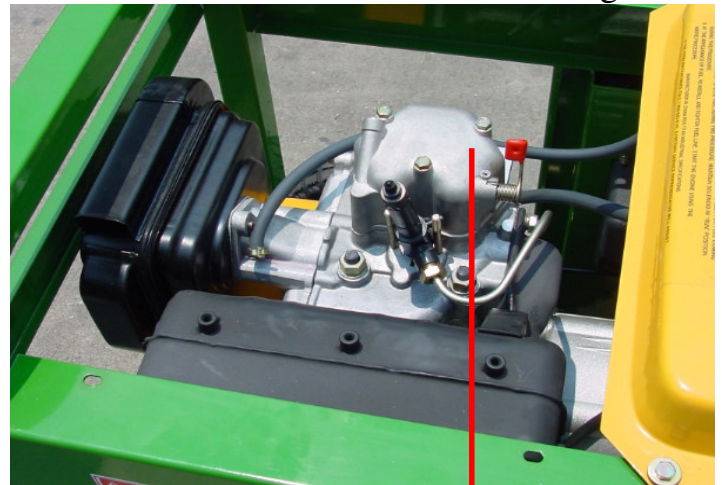

Figure #8



Valve Cover

Valve Settings
 .012-intake
 .013-exhaust

TDC see page 20

RECEPTACLES

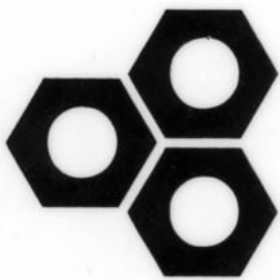
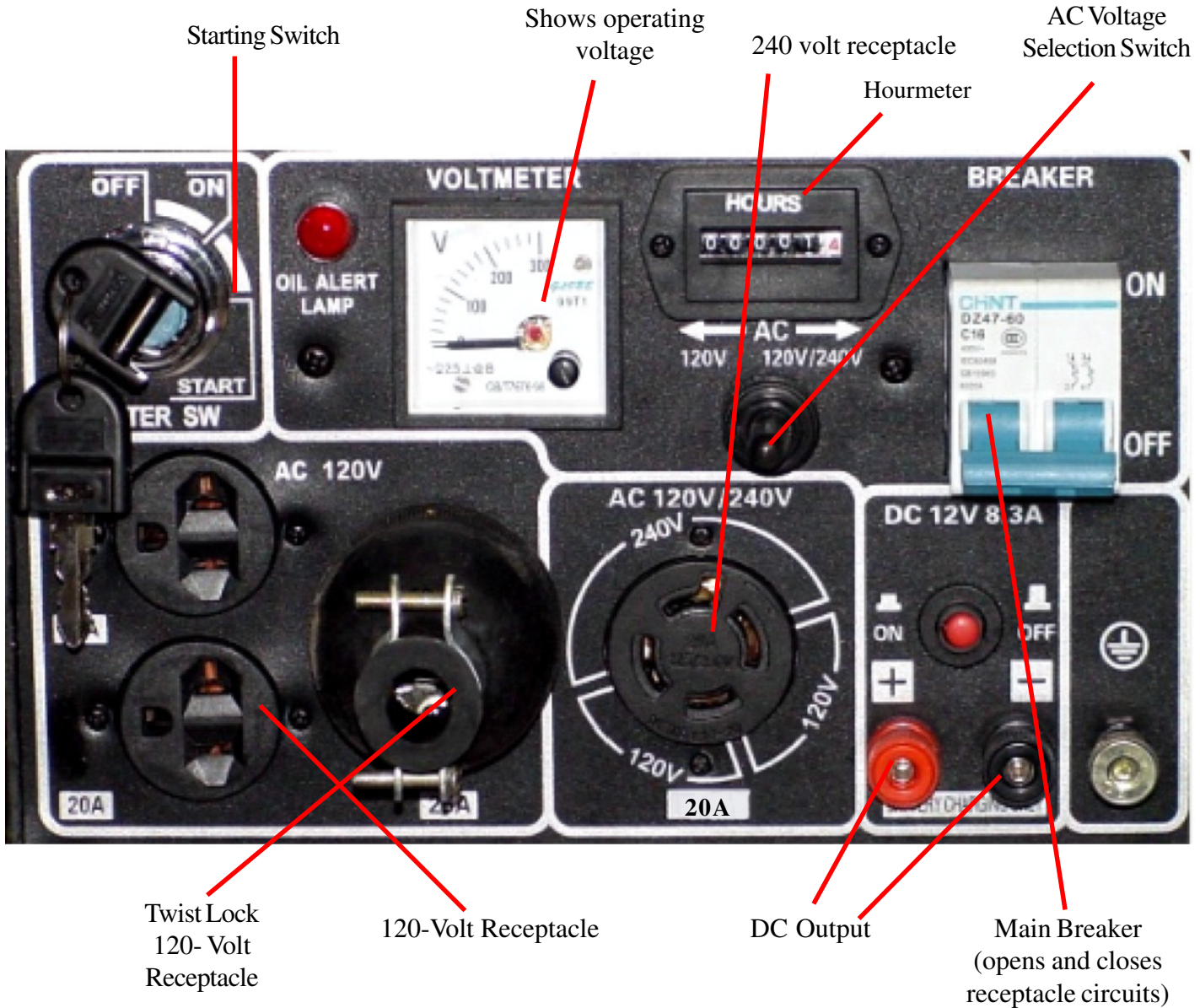

TITAN
I N D U S T R I A L

TROUBLESHOOTING

Problem	Cause	Solution
Engine is running but no power output is available.	<ol style="list-style-type: none"> 1. Circuit breaker is open. 2. Poor connection or defective cord set. 3. Connected device is bad. 4. Fault in generator. 	<ol style="list-style-type: none"> 1. Reset the circuit breaker. 2. Check & repair. 3. Connect another device that is in good condition. 4. Contact service center.
Engine runs good until loads are connected, then bogs down.	<ol style="list-style-type: none"> 1. Short circuit in a connected load. 2. Overloaded generator. 3. Engine speed is too slow. 4. Short in generator circuit. 	<ol style="list-style-type: none"> 1. Disconnect shorted load. 2. See 'Connecting Electrical Loads' section of manual. 3. Contact service center. 4. Contact service center.
Engine will not start or engine starts but runs rough.	<ol style="list-style-type: none"> 1. On/Off Switch is turned 'OFF'. 2. Battery is dead 3. Dirty air cleaner. 4. Out of diesel fuel. 5. Stale diesel fuel. 6. Not enough speed or force is used for recoil start. 7. Water in diesel fuel. 8. Speed control is not set to "RUN". 9. Low oil level. 10. Oil nozzle is dirty. 11. Engine has lost compression. 	<ol style="list-style-type: none"> 1. Turn On/Off Switch to 'ON'. 2. Charge or replace it. 3. Clean air filter 4. Fill fuel tank. 5. Drain fuel tank and refill. 6. Read and follow directions. 7. Drain and refill tank. 8. Move speed control to "RUN" position. 9. Add oil to proper level. 10. Clean oil nozzle. 11. Contact service center.
Engine shuts down during operation.	<ol style="list-style-type: none"> 1. Out of diesel fuel. 2. Fault in engine. 	<ol style="list-style-type: none"> 1. Fill fuel tank. 2. Contact service center
Engine lacks power	<ol style="list-style-type: none"> 1. Load is too high. 2. Dirty air filter. 3. Engine needs to be serviced. 	<ol style="list-style-type: none"> 1. See 'Connecting Electrical Loads' section of manual. 2. Replace the air filter. 3. Contact service center.

Service
1-800-845-4141



Fax
864-834-5127

Replacement Parts
1-800-845-4141

Toll Free 1-800-845-4141
www.titanindustrial.com

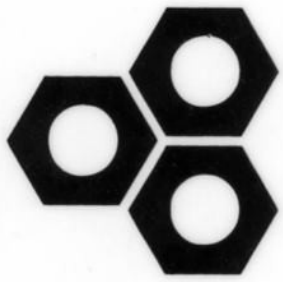

TITAN

I N D U S T R I A L



Parts Catalog

P.O.Box 791, Travelers Rest, S.C. 29690
Phone 864-834-7212
Service/Replacement Parts 800-845-4141

1. Cylinder Block Assembly

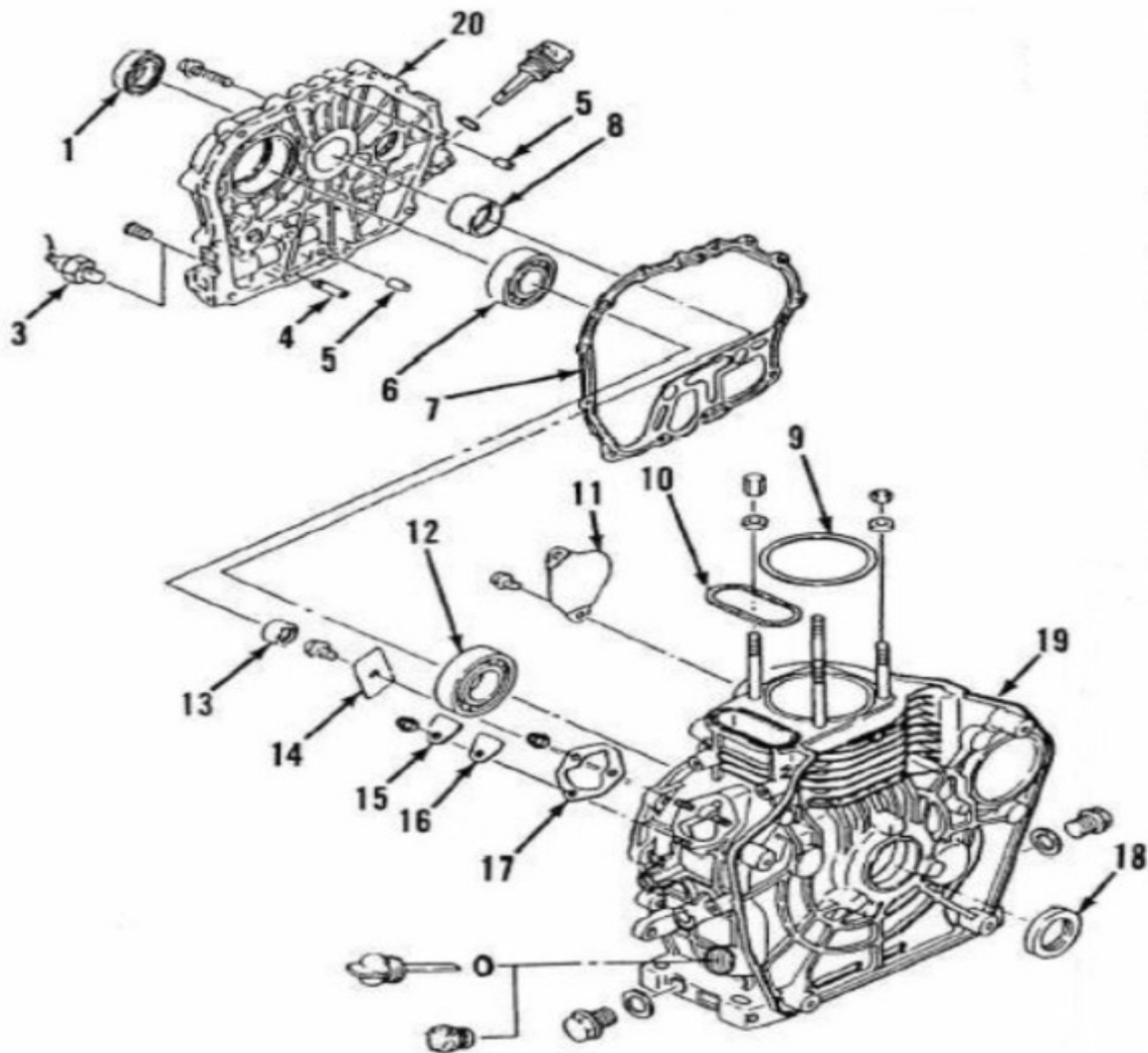

<u>Part Name</u>	<u>Titan Part #</u>	<u>Part Name</u>	<u>Titan Part #</u>
1. PTO Seal	LCT-7552	12. Crank Shaft Bearing	LCT-7515
3. Oil Sensor	LCT-016	13. CamShaft Bearing	LCT-7514
4. Oil Pipe	LCT-7528	14. Bearing Retainer Plate	LCT-7543
5. Dowel Pins	LCT-7528	15. Fuel Pump cover	LCT-7537
6. Cam Shaft Bearing	LCT-7528	16. Fuel Pump Gasket	LCT-7537
7. Crank Case Cover Gasket	LCT-7529	17. Fuel Pump Shims	LCT-7536
8. Main Bearing	LCT-7557	18. CrankShaft Oil Seal	LCT-7552
9. Cylinder Head Gasket	LCT-7520	19. Cylinder Block	LCT-7553
10. Push Rod O-ring	LCT-7513	20. Crank Case Cover	LCT-7528
11. Starter Cover Plate	N/A		

Some Parts Sold As Assemblies

2. Crank Shaft Assembly

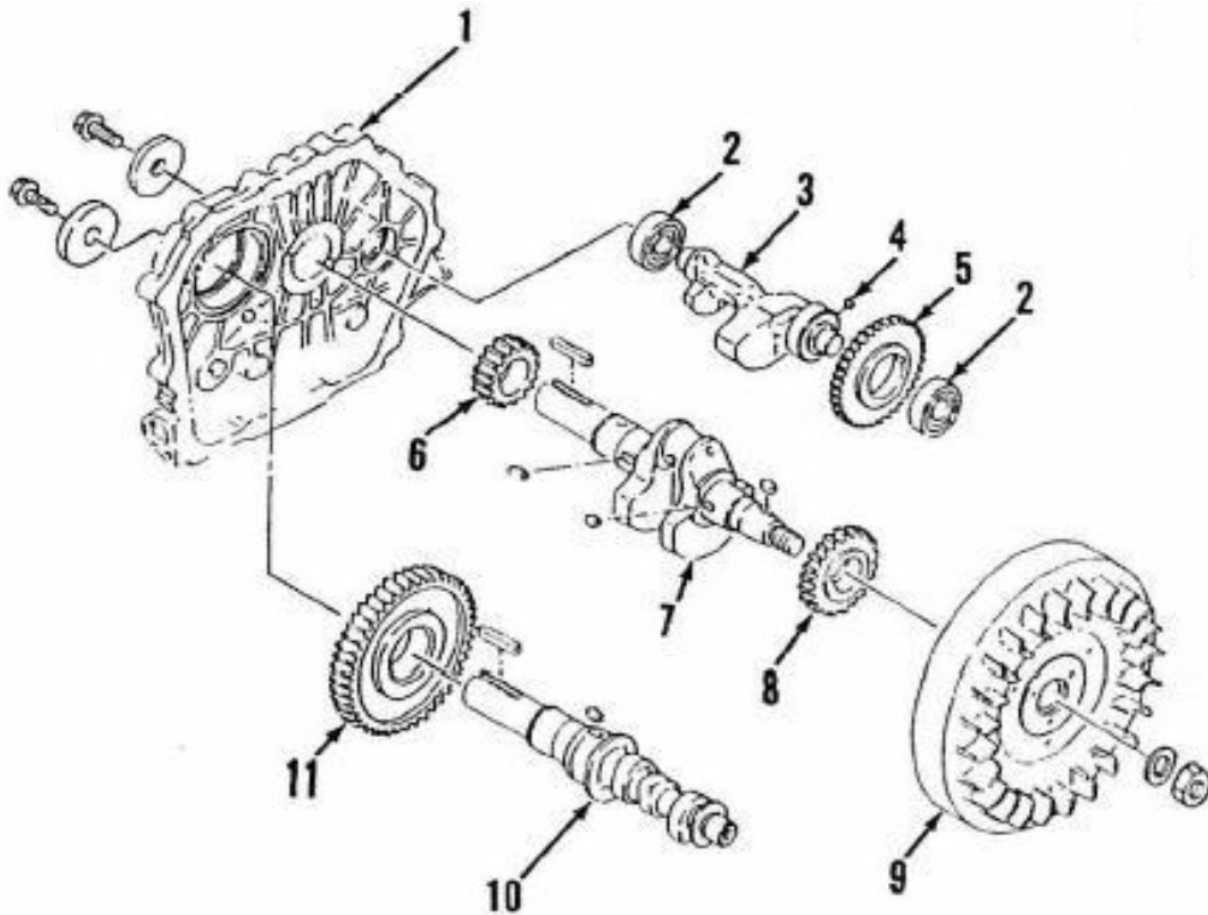

Part Name

Titan Part

1. Crank Case Cover	LCT-7520
2. Balancer Shaft Bearing	LCT-7522
3. Balancer Shaft	LCT-7522
4. Key	LCT-7522
5. Balancer Shaft Gear	LCT-7522
6. Camshaft Drive Gear	LCT-7515
7. Crankshaft	LCT-7515
8. Balancer Shaft Drive Gear	LCT-7515
9. Flywheel	LCT-7551
10. Camshaft	LCT-7514
11. Cam Shaft Drive Gear	LCT-7514

Some Parts Sold As Assemblies

3. Governor Gear Assembly

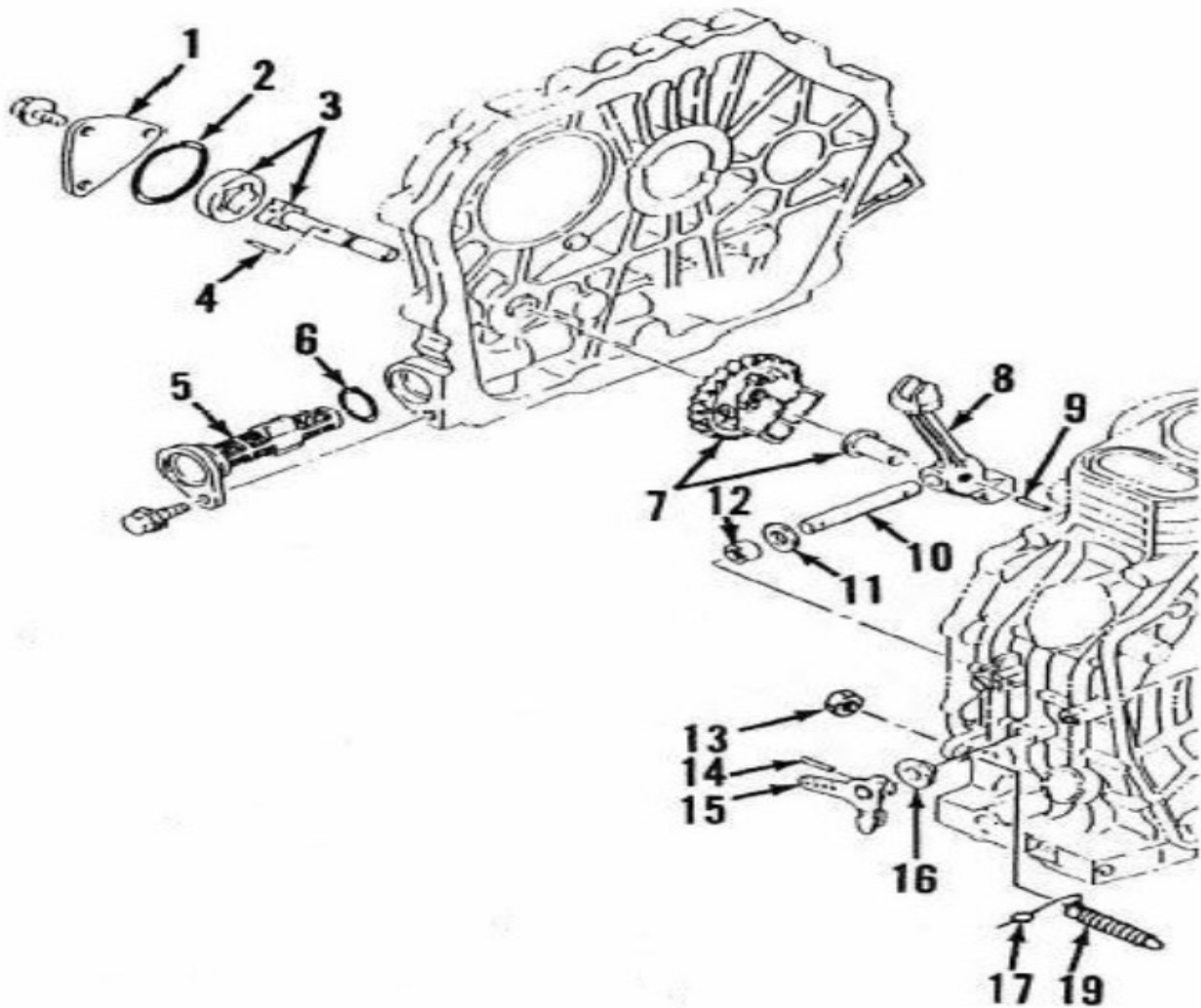

<u>Part Name</u>	<u>Titan Part #</u>	<u>Part Name</u>	<u>Titan Part #</u>
1. Oil Pump	LCT-7522	10. Governor Arm Shaft	LCT-7525
2. Oil Pump O-ring	LCT-7527	11. Flat Washer	N/A
3. Oil Pump Rotor	LCT-7523	12. Governor Shaft Bearing	N/A
4. Oil Pump Drive Pin	LCT-7523	13. Lock Nut	LCT-7526
5. Oil Filter\Screen	LCT-015	14. Dowel Pin	LCT-7525
6. O-Ring	LCT-015	15. Governor Arm	LCT-7525
7. Governor Assembly	LCT-7523	16. Thrust Bearing	LCT-7525
8. Governor Arm	LCT-7525	17. Seal Wire	N/A
9. Dowel Pin	LCT-7525	19. Governor Stop	LCT-7526

Some Parts Sold As Assemblies

4. Head Assembly

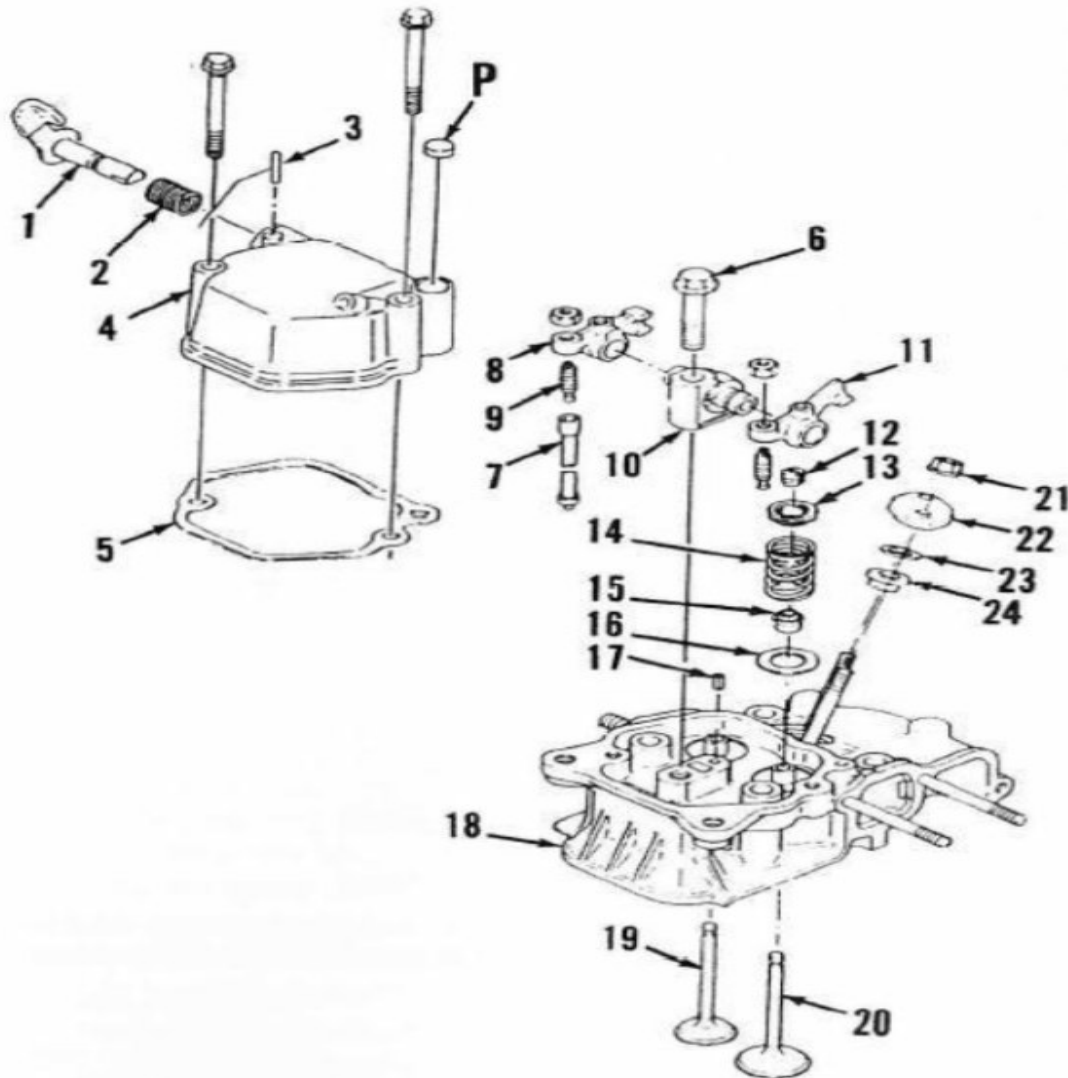

<u>Part Name</u>	<u>Titan Part #</u>	<u>Part Name</u>	<u>Titan Part #</u>
1. Decompression Lever	N/A	13. Valve Keepers	LCT-7511
2. Return Spring	N/A	14. Valve Spring	LCT-7511
3. Retaining Pin	N/A	15. Valve Guide Seal	LCT-7511
4. Valve Cover	LCT-7530	16. Spring Seat Washer	N/A
5. Valve Cover Gasket	LCT-7531	17. Pedestal Dowel Pin	LCT-7501
6. Rocker Pedestal Bolt	LCT-7541	18. Cylinder Head	LCT-7501
7. Push Rod	LCT-7512	19. Exhaust Valve	LCT-7511
8. Exhaust Rocker Arm	LCT-7541	20. Intake Valve	LCT-7511
9. Adjusting Screw	LCT-7541	21. Injector Clamp Nuts	LCT-7504
10. Rocker Arm Pedestal	LCT-7541	22. Injector Clamp Plate	LCT-7504
11. Intake Rocker Arm	LCT-7541	23. Injector Spacer	N/A
12. Split Valve Locks	LCT-7511	24. Injector Gasket	LCT-7503

Some Parts Sold As Assemblies

5. Piston Assembly

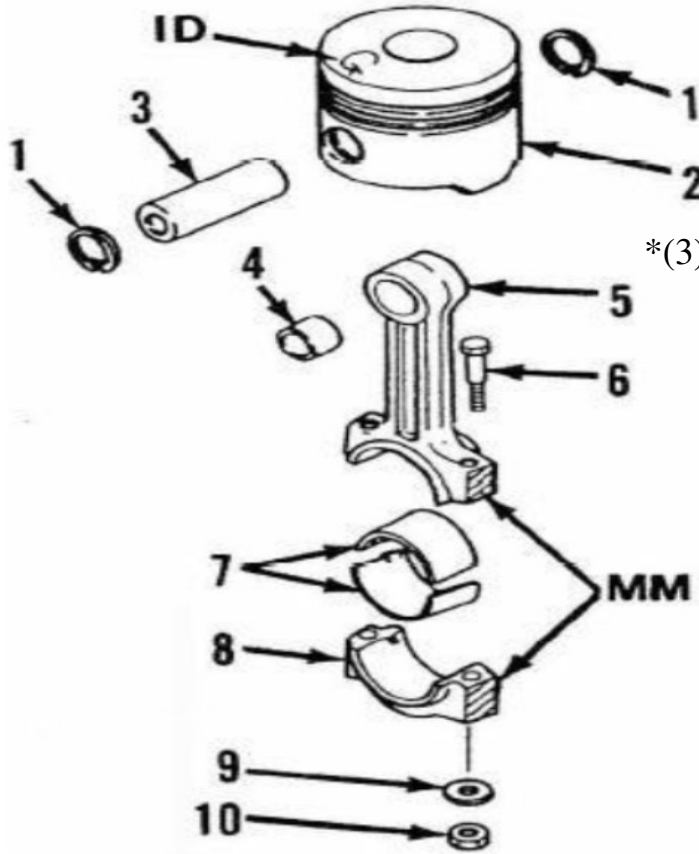

*(3) Piston Rings Not Shown
Part # LCT-5519

Part Name

Titan Part

Part Name

Titan Part

- 1. Snap Rings
- 2. Piston
- 3. Piston Pin
- 4. Pin Bushing
- 5. Connecting Rod

- LCT-7516
- LCT-7516
- LCT-7516
- LCT-7517
- LCT-7517

- 6. Rod Cap Bolt
- 7. Rod Sleeve Bearing
- 8. Rod Cap
- 9. Washer
- 10. Nut

- LCT-7517
- LCT-7517
- LCT-7517
- NA
- NA

6. Fuel Injection System



Fuel Injector LCT-7502



Fuel Pump LCT-7535

These Parts Sold As Assemblies

7. Fuel System

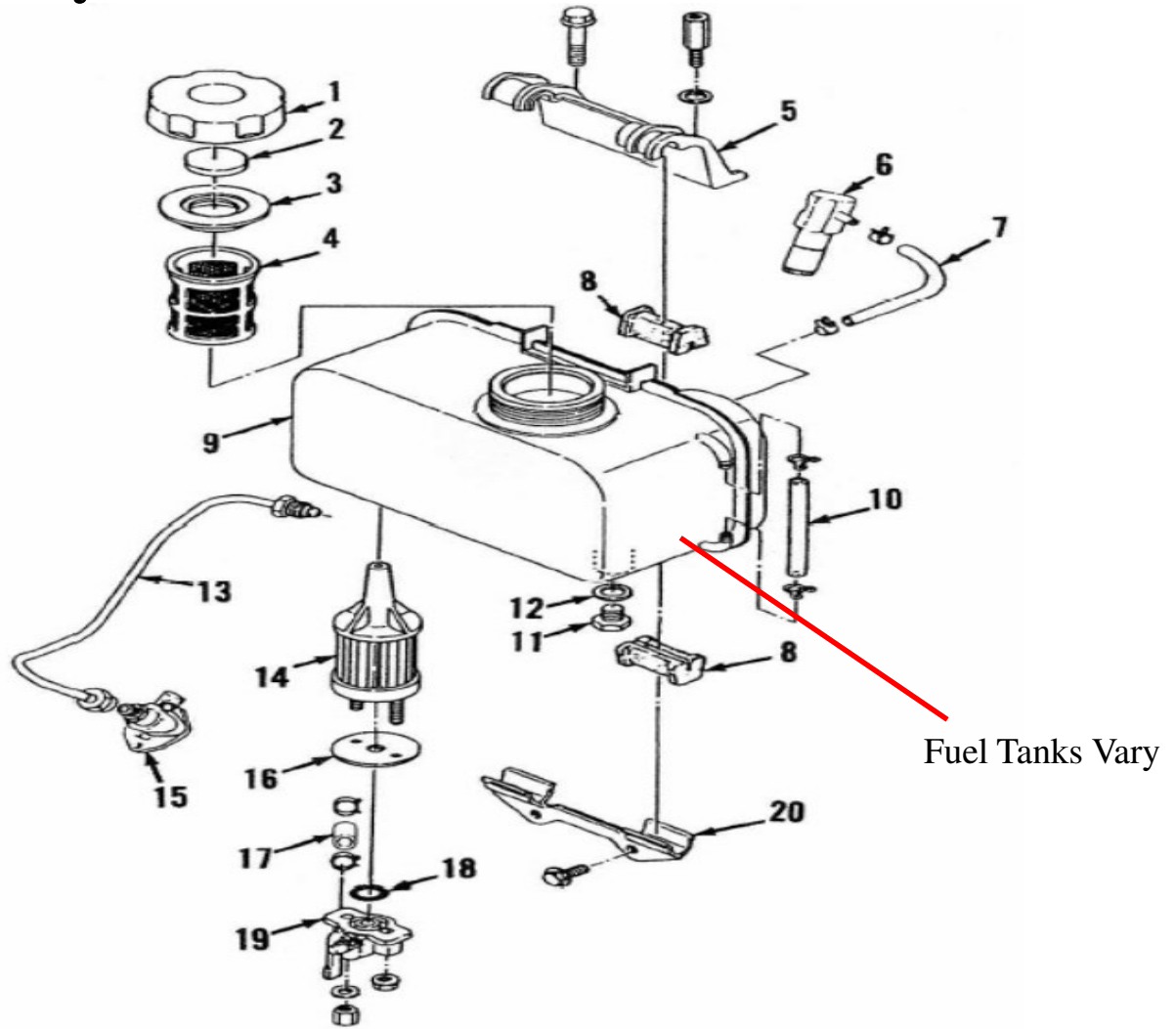

<u>Part Name</u>	<u>Titan Part #</u>	<u>Part Name</u>	<u>Titan Part #</u>
1. Fuel Cap	LCT-009	11. Drain Plug	N/A
2. Fuel Cap Seal	LCT-009	12. Gasket	NA
3. Fuel Cap Gasket	LCT-009	13. Fuel Injector Line	LCT-7550
4. Filter Screen	LCT-009A	14. Fuel Filter	LCT-010
5. Mounting Clamp	N/A	15. Fuel Injector Pump	LCT-7535
6. Fuel Injector	LCT-7502	16. Fuel Filter Plate	LCT-10A
7. Fuel Return line	LCT-057	17. Rubber Fuel Line	LCT-056
8. Vibration Dampers	N/A	18. O-ring	LCT-011
9. Fuel Tank	LCT-008	19. Fuel Shut Off Valve	LCT-012
10. Fuel Gauge	LCT-008A	20. Mounting Clamp	NA

Some Parts Sold As Assemblies

8. Starter Assembly

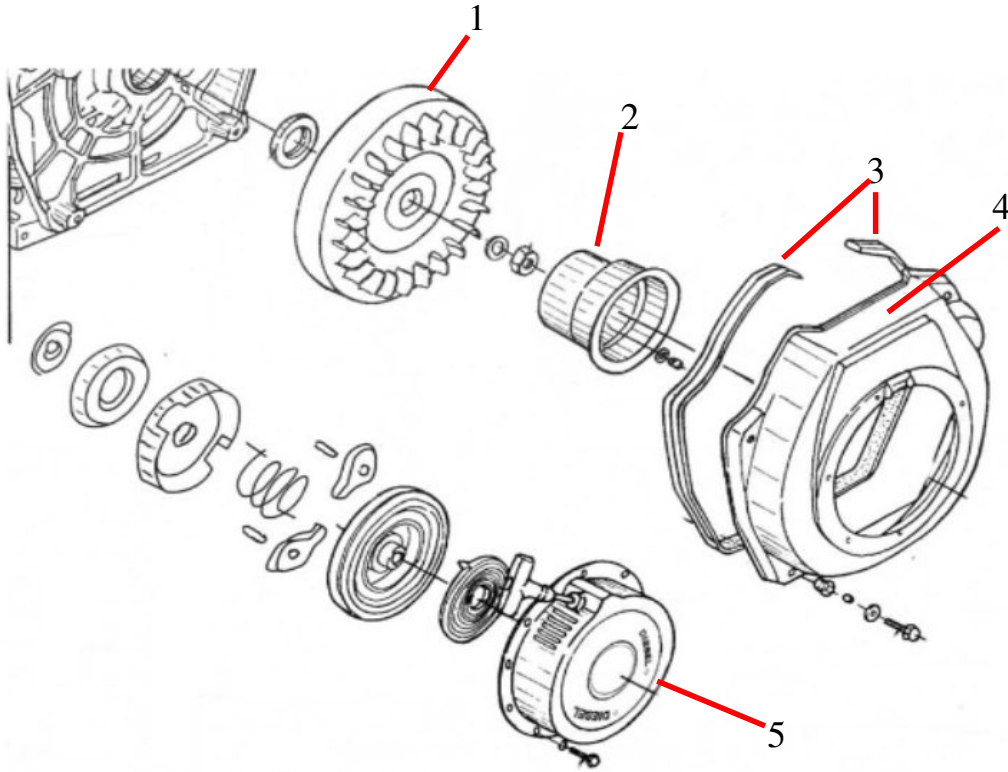

Part Name

Titan Part

1. Fly Wheel
2. Recoil Cup
3. Blower Housing Gaskets
4. Blower Housing
5. Recoil Assembly

LCT-7551
LCT-7544
LCT-7546
LCT-7545
LCT-7542

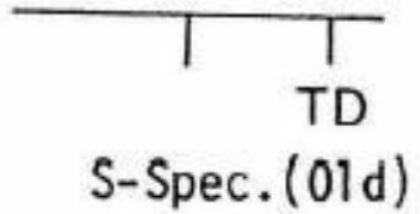
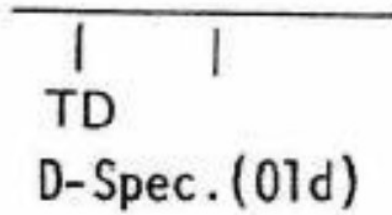
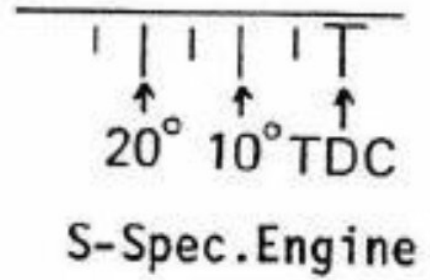
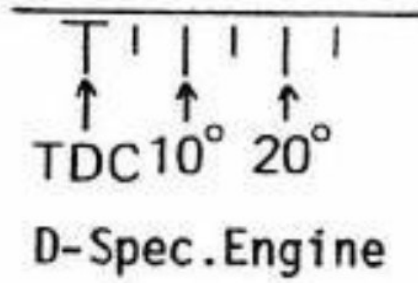

Engine Timing
Reference Information

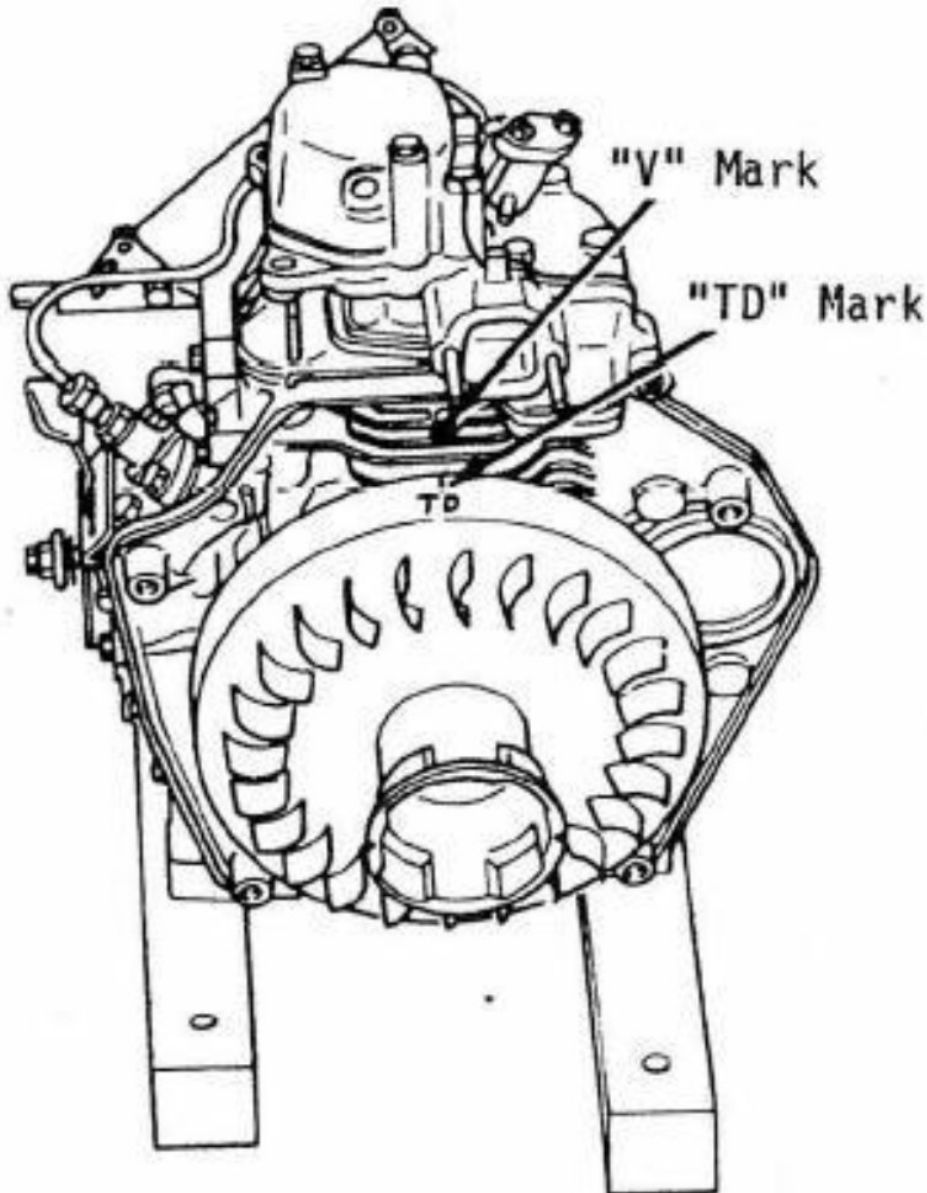



LIQUID COMBUSTION TECHNOLOGY

Part	Item/Model	HL
Engine	Maximum speed	37
	Idle speed	18
	Envelope Size	417mm
	Cylinder compression	
Cylinder	Sleeve	
	Stroke	
Cylinder head	Warpage	
Piston Pin & Rings	1st ring side clearance	.06
	2nd Ring side clearance	.01
	Oil ring side clearance	.01
	Pin O.D.	22.1
	End Gap 1st&2nd Oil	.10 - .25
Conn-rod	Small end I.D.	23.02

The list of control torque on the 178 Diesel engine assembling line

Item	Torque(N.M)	Gap/Torque SAE		
		Lower	Upper	
Valve Rocker Arm Support	13-15	10	11	lb-ft
Flywheel End Nut	150-160	111	118	lb-ft
Crankcase Cover Bolt	18-23	13	17	lb-ft
Cylinder Head Nuts	42-46	31	34	lb-ft
Connecting Rod Bolts	28-30	21	22	lb-ft
FO Pump Stud Bolt (Stud Side)	30-35	22	26	
FO Nozzle Case Nut	40-45	30	33	
FO Injection Nozzle Nuts	10-12	7	9	
FO Pump Nuts	10-12	7	9	
Standard Bolts and Nuts (M6)	7-10	6	7	
Standard Bolts and Nuts (M8)	18-20	13	15	



5.96



P.O.Box 791, Travelers Rest, S.C. 29690
 Phone 864-834-7212
 Service/Replacement Parts 800-845-4141

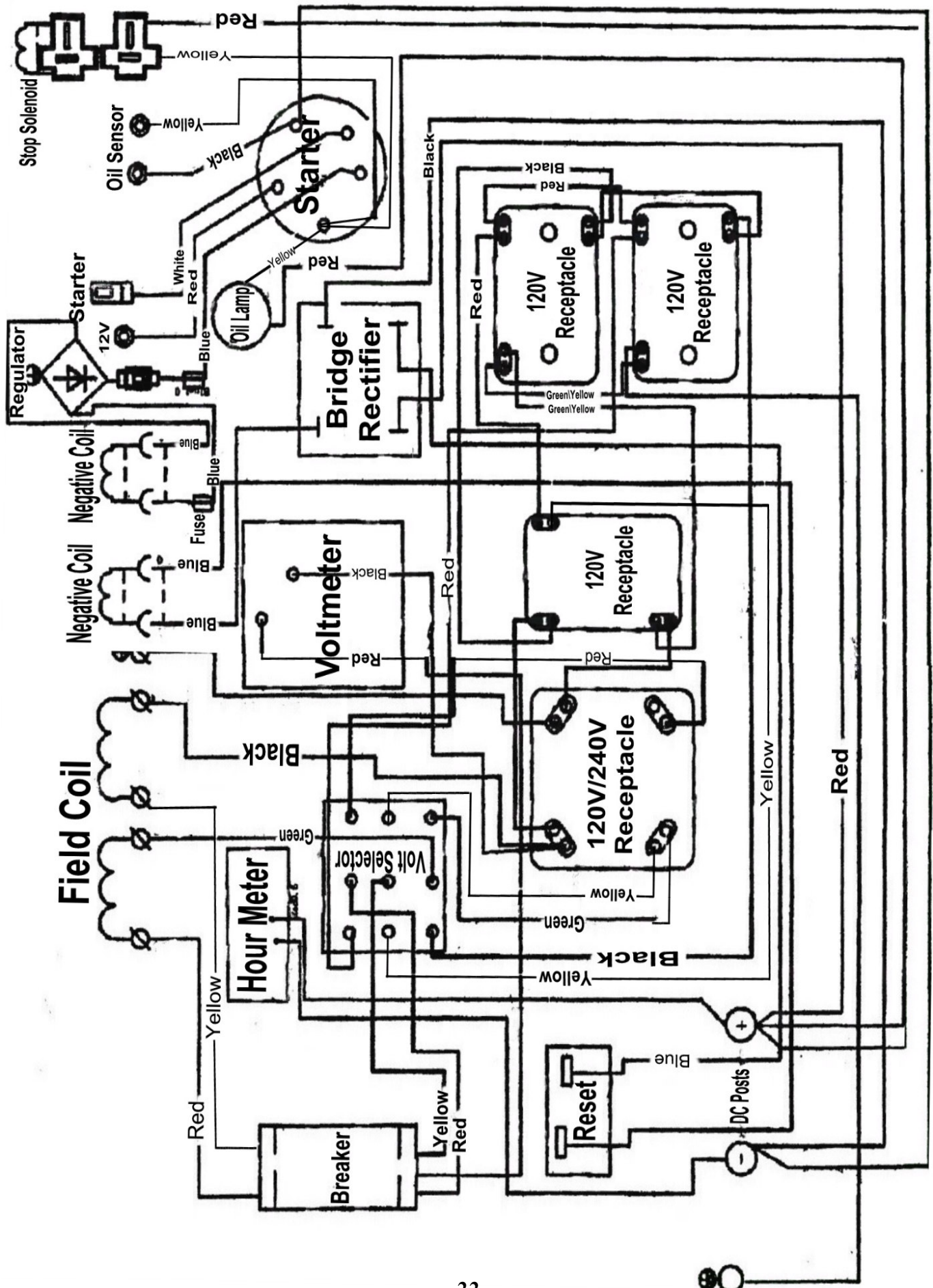

TITAN INDUSTRIAL

P.O. Box 791
Travelers Rest, S.C. 29690
(800) 845-4141
www.titanindustrial.net

Model 7500



Specifications:

- Output 6000watts Continuous-
6800watts Surge
- 2- L5-20 Receptacles
- 1- L14-20 Receptacle
- Circuit Breaker Protection
- 84 Decibel's @ 10'
- Electric Start\Manual Recoil
- 9hp Titan Diesel Engine
- Steel Sleeve Cylinder
- 3.5 Gallon Fuel Tank
- Approx. Run Time 10hrs
@50% Load
- Rpm 3720
- Brushless Generator Head
- Copper Windings
- Single Phase 60Hz.
- Low Oil Shut Down
- Oil Capacity 1.2U.S. qts.
- Size: L-29" W-19" H-26"
- Net. Weight 280LBS.
- One Year Warranty (Residential)
90day (Commercial)

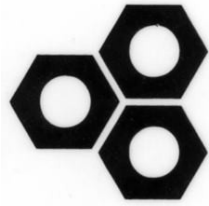

TITAN
I N D U S T R I A L



7500 Industrial Diesel Generator

P.O.Box 791, Travelers Rest, S.C. 29690
Phone 864-834-7212
Service/Replacement Parts 800-845-4141